

## AE50/AM50 Series Specifications

		Manufacturer's Designation		FB10-12	FB14-12	FB15-12	FB18-12	FB20A-12	FB15G-12	FB18G-12	FB20AG-12	FB10M-12	FB13M-12	FB15M-12	FB18M-12	FB20M-12		
Characteristics	1.2	Model																
	1.3	Power Type	Electric, Diesel, Gasoline, LPG, Cable		Electric	Electric	Electric	Electric	Electric	Electric	Electric	Electric	Electric	Electric	Electric	Electric		
	1.4	Operation Type			Sitting	Sitting	Sitting	Sitting	Sitting	Sitting	Sitting	Sitting	Sitting	Sitting	Sitting	Sitting		
	1.5	Rated Capacity	Q	Rated Capacity	kg	1000	1350	1500	1750	2000	1500	1750	2000	1000	1250	1500	2000	
	1.6	Load Center	c	Rated Load Center	mm	500	500	500	500	500	500	500	500	500	500	500	500	
	1.6.1	Alternative Capacity	Q2	Capacity@600mm Load Center	kg	900	1210	1350	1570	1800	1350	1570	1800	900	1210	1350	1570	1800
	1.8	Load Distance	x	Front Axle Center to Fork Face	mm	400	405	405	405	425	405	405	425	400	400	405	405	425
	1.9	Wheelbase	y		mm	1410	1410	1410	1410	1470	1540	1540	1540	1190	1190	1340	1390	1485
	2.1	Service Weight	Including Min. Capacity Battery, See line 6.5		kg	2770	2790	2930	3170	3620	3360	3390	3730	2600	2710	2980	3260	3730
Weight	2.2	Axle Loading	Loaded	Front	kg	3080	3680	3980	4400	5020	4060	4540	5010	3100	3540	4000	4430	5080
	Rear			kg	690	460	450	520	600	800	650	720	500	420	480	580	650	
	2.3		Unloaded	Front	kg	1410	1440	1490	1490	1720	1680	1680	1810	1310	1310	1460	1510	1790
	2.3.1			Rear	kg	1360	1350	1440	1680	1900	1680	1710	1920	1290	1400	1520	1750	1940
Tyres	3.1	Tyre Type	Cushion, Elastic Cushion, Pneumatic, Polyurethane		Pneumatic	Pneumatic	Pneumatic	Pneumatic	Elastic Cushion	Pneumatic	Pneumatic	Elastic Cushion	Pneumatic	Pneumatic	Pneumatic	Elastic Cushion		
	3.2	Tyre Size	Front		18x7-8-16PR(I)	18x7-8-16PR(I)	18x7-8-16PR(I)	18x7-8-16PR(I)	200/50-10	18x7-8-16PR(I)	18x7-8-16PR(I)	200/50-10	18x7-8-16PR(I)	18x7-8-16PR(I)	18x7-8-16PR(I)	200/50-10		
	3.3		Rear		16x6-8-10PR(I)	16x6-8-10PR(I)	16x6-8-10PR(I)	16x6-8-10PR(I)	16x6-8	16x6-8-10PR(I)	16x6-8-10PR(I)	16x6-8	15x4 1/2-8-12PR(I)	15x4 1/2-8-12PR(I)	15x4 1/2-8-12PR(I)	15x4 1/2-8-12PR(I)	15x4 1/2-8	
	3.5	Number of Wheel	Front/Rear (x=driven)			2x/2	2x/2	2x/2	2x/2	2x/2	2x/2	2x/2	2x/2	2x/2	2x/2	2x/2	2x/2	
	3.6	Tread, Front	b10		mm	940	940	940	940	950	940	940	950	940	940	940	950	
	3.7	Tread, Rear	b11		mm	865	865	865	865	865	865	865	865	170	170	170	170	
	Dimensions	4.1	Tilting Angle	$\alpha / \beta$	Forward/Backward	degree	6/10	6/10	6/10	6/10	6/10	6/10	6/10	6/10	6/10	6/10	6/10	
4.2		Mast Height, Lowered	h1	2-stage Mast	mm	1995	1995	1995	1995	2110	1995	1995	2110	1995	1995	2110		
4.3		Std. Free Lift	h2	2-stage Std. Mast, from Ground	mm	135	140	140	140	150	140	140	150	135	135	140	150	
4.4		Std. Lift Height	h3	2-stage Std. Mast, from Ground	mm	3000	3000	3000	3000	3000	3000	3000	3000	3000	3000	3000	3000	
4.5		Mast Height, Extended	h4	2-stage Std. Mast	mm	3955	3955	3955	3955	3970	3955	3955	3970	3955	3955	3955	3970	
4.7		Height, Overhead Guard	h6		mm	2070	2070	2070	2070	2070	2070	2070	2070	2070	2070	2070	2070	
4.19		Length, with Std. Forks	l1		mm	2825	2980	2980	3015	3100	3115	3115	3170	2560	2560	2855	2920	3035
4.20		Length, to Fork Face	l2		mm	2055	2060	2060	2095	2180	2195	2195	2250	1790	1790	1935	2000	2115
4.21		Width, at Tyre	b1	Single	mm	1110	1110	1110	1110	1160	1110	1110	1160	1110	1110	1110	1160	
4.22		Forks	s/e/l	Thickness / Width / Length	mm	31x100x770	35x100x920	35x100x920	35x100x920	36x122x920	35x100x920	35x100x920	36x122x920	31x100x770	31x100x770	35x100x920	35x100x920	36x122x920
4.23		Fork Carriage Class	ISO 2328, Type A/B/no			Class 2, Type A	Class 2, Type A	Class 2, Type A	Class 2, Type A	Class 2, Type A	Class 2, Type A	Class 2, Type A	Class 2, Type A	Class 2, Type A	Class 2, Type A	Class 2, Type A	Class 2, Type A	
4.24		Width, Fork Carriage	b3		mm	970	970	970	970	970	970	970	970	970	970	970	970	
4.31		Ground Clearance	m1	Under Mast	mm	95	95	95	95	95	95	95	95	95	95	95	95	
4.32			m2	at Center of Wheelbase	mm	125	125	125	125	125	125	125	125	125	125	125	125	
4.33		Right Angle Stacking Aisle	Ast	with L1000 x W1200 pallet	mm	3150	3155	3155	3190	3275	3335	3335	3395	2790	2935	2995	3115	
4.34	Ast		with L1200 x W800 pallet	mm	3350	3355	3355	3390	3475	3535	3535	3595	2990	2990	3135	3195	3315	
4.35	Turning Radius	Wa		mm	1750	1750	1750	1785	1850	1930	1930	1970	1390	1390	1530	1590	1690	
Performance	5.1	Travel Speed (FWD)	Loaded / Unloaded		km/h	15.0/17.0	15.0/17.0	15.0/17.0	15.0/17.0	14.0/16.0	15.0/17.0	15.0/17.0	14.0/16.0	15.0/17.0	15.0/17.0	14.0/16.0		
	5.2	Lifting Speed	Loaded / Unloaded		mm/s	340/600	340/600	340/600	320/600	280/500	340/600	320/600	280/500	340/600	340/600	340/600	320/600	280/500
	5.3	Lowering Speed	Loaded / Unloaded		mm/s	450/550	450/550	450/550	450/550	370/440	450/550	450/550	370/440	450/550	450/550	450/550	370/440	
	5.6	Max. Drawbar Pull	Loaded, 3min. rating		N	9560	9560	9560	9560	9045	9560	9560	9045	9560	9560	9560	9045	
	5.8	Max. Gradeability	Loaded, 3min. rating/1.5/h		%	19	19	19	19	14	16	16	14	19	19	16	14	
	5.10	Service Brake	Operation/Control			Foot/Hydraulic	Foot/Hydraulic	Foot/Hydraulic	Foot/Hydraulic	Foot/Hydraulic	Foot/Hydraulic	Foot/Hydraulic	Foot/Hydraulic	Foot/Hydraulic	Foot/Hydraulic	Foot/Hydraulic	Foot/Hydraulic	
	5.10.1	Parking Brake	Operation/Control			Hand/Mechanical	Hand/Mechanical	Hand/Mechanical	Hand/Mechanical	Hand/Mechanical	Hand/Mechanical	Hand/Mechanical	Hand/Mechanical	Hand/Mechanical	Hand/Mechanical	Hand/Mechanical	Hand/Mechanical	
5.10.2	Steering	Type			FHPS	FHPS	FHPS	FHPS	FHPS	FHPS	FHPS	FHPS	FHPS	FHPS	FHPS	FHPS		
Drive	6.1	Drive Motor(AC)	60min.rating		kW	4.5x2	4.5x2	4.5x2	4.5x2	4.5x2	4.5x2	4.5x2	4.5x2	4.5x2	4.5x2	4.5x2		
	6.2	Pump Motor(AC)	5 min.rating		kW	9.0	9.0	9.0	9.0	9.0	9.0	9.0	9.0	9.0	9.0	9.0		
	6.4	Battery Voltage			V	48	48	48	48	48	48	48	48	48	48	48	48	
	6.4.1	Battery Capacity,Min			Ah/5hr	330	330	402	402	468	645	645	645	280	280	402	468	
	6.4.2	Battery Capacity,Max			Ah/5hr	565	565	565	565	565	725	725	725	370	370	565	565	
6.5	Battery Weight	Min.Capacity Battery,See line 6.4.1		kg	610	610	720	720	760	1000	1000	1000	515	515	720	720	760	
Others	8.1	Drive Motor Control				Transistor	Transistor	Transistor	Transistor	Transistor	Transistor	Transistor	Transistor	Transistor	Transistor	Transistor		
	8.2	Relief Pressure Attachment			bar	176	176	176	176	176	176	176	176	176	176	176		
	8.2.1	Hydraulic Oil Capacity			Ltr	23	23	23	23	23	23	23	23	23	23	23		

### Dimensions/AE50 Series

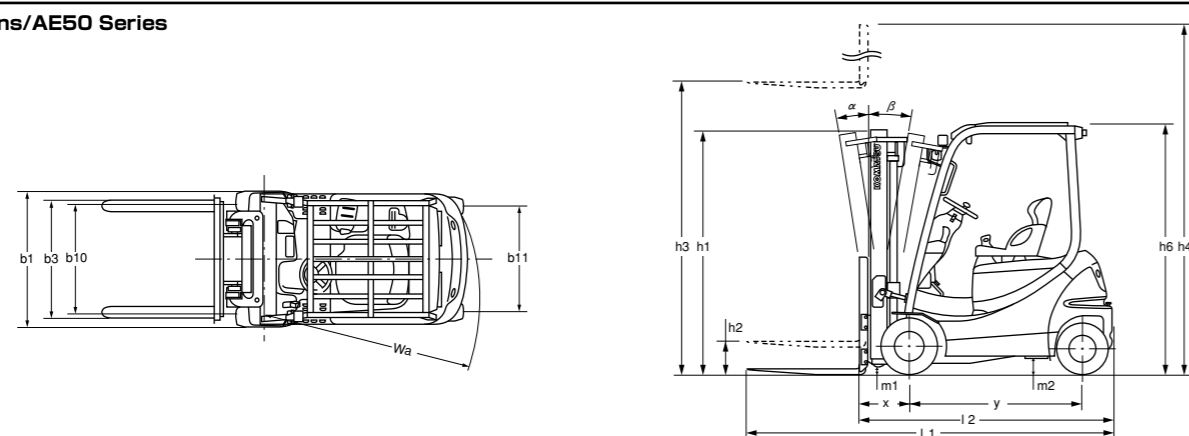

### Dimensions/AM50 Series

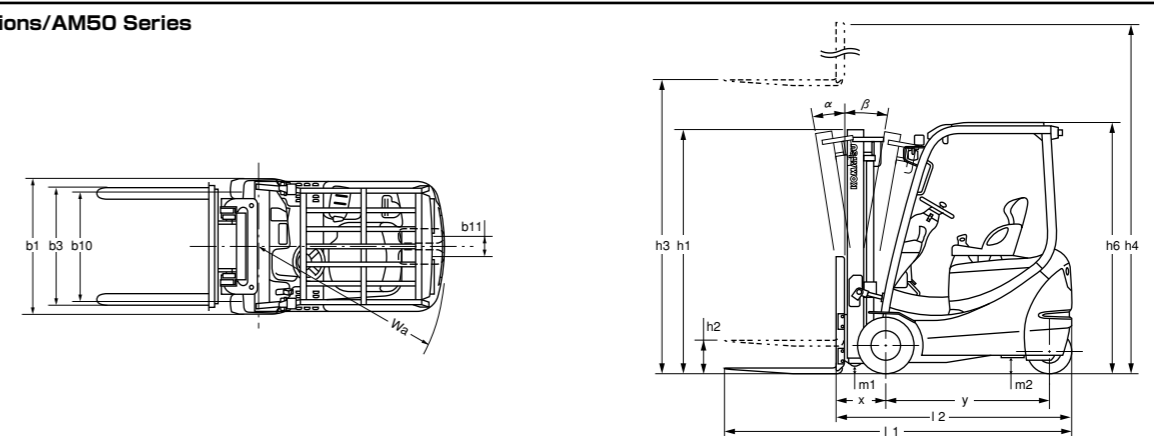

# Major Equipment

● : Standard ○ : Option △ : Available upon Request — : N/A S : Adjustable by service mechanic

		AE50 Series/4-wheel		AM50 Series/3-wheel
		Standard Truck	Large Capacity Battery Truck	Standard Truck
		1.0~2.0t	1.5~2.0t	1.0~2.0t
ICS (Intelligent Computer Control System)		●	●	●
Mortors	Traveling Mortor	AC	AC	AC
	Hydraulic and Steering Motor	AC	AC	AC
All-around Dual Drive		●	●	●
Airtight Wet Disc Brake		●	●	●
Proportional Hydraulic Control Valve		●	●	●
Combination Lever (Forward/Reverse switch integrated)		●	●	●
Steering Type		FHPS	FHPS	FHPS
Setup	Traveling Property Adjustment	Traveling Speed Property	●	●
		Plugging Regeneration Property	●(S)	●(S)
		Brake Regeneration Property	●(S)	●(S)
		Soft-start Property	●(S)	●(S)
		Accelerator Property	●(S)	●(S)
		Accelerator Neutral Regeneration Property	●(S)	●(S)
		Slope Regeneration	●(S)	●(S)
	Hydraulic Operation Property Adjustment	Traveling Speed Control	●	●
		Lifting Speed Adjustment	●	●
		Tilting Speed Adjustment	●(S)	●(S)
Regeneration	Attachment Speed	●(S)	●(S)	
	Plugging Regeneration	●	●	
	Brake Regeneration	●	●	
	Accelerator Neutral Regeneration	●	●	
IMS (Intelligent Monitoring System)	Speedometer	●	●	
	Forward/Reverse Indicator	●	●	
	Speed Limit Indicator	●	●	
	Calender/ Service meter	●	●	
	Traveling Power Indicator	●	●	
	Battery Discharge Indicator	●	●	
	Fork Leveling Indicator	○	○	
	Load Checker(10kg unit)	○	○	
	Parking Brake Indicator	●	●	
	Neutral Safety Indicator	●	●	
Operation Equipment Related	Traveling OPS Warning Lamp	●	●	
	Lifting OPS Warning Lamp	●	●	
	Failure Indicator	●	●	
	Electrolyte Level Indicator	●	●	
Safety Support Equipment	Telescopic-tiltable Steering Column	●	●	
	Auto-return Turning Signal Lever	●	●	
	Soft-landing Device	●	●	
	Operator Presence Sensing System (Lifting/Traveling Interlocking Mechanism)	●	●	
	Emergency Switch	●	●	
	Neutral Safety	●	●	
	Automatic Power Off	●	●	
	Anti Roll-back	●	●	
	Traveling Speed Control	●	●	
	Key-off Lift Lock	●	●	
Supportive Equipment for Hydraulic Operation	Parking Brake with release button	●	●	
	Back-up Buzzer	●	●	
	Load Checker	○	○	
	Forward/Back-up Chime	○	○	
	Rear View Mirror (Left & Right)	○	○	
	Wide-angle Center Mirror	●	●	
	Rear Working Light	○	○	
Exterior	Strobe Light (yellow/red/blue)	○	○	
	Fire Extinguisher	○	○	
	Automatic Fork Leveling Device	○	○	
	Laser Lift Height Sensor	○	○	
Others	Automatic Lifting Stop Function	△	△	
	Softcarry (Hydraulic Accumulator)	○	○	
	Floor Mat	●	●	
	HSS II Seat (with seat belt)	●	●	
Battery Related	Steel Cabin	△	△	
	Windshield Wiper (with window washer)	○	○	
	Protective Resin Head Guard Cover	○	○	
Battery Related	Seat Heater	○	○	
	Pen Tray	●	●	
Battery Related	Paper Binder	●	●	
	Side Battery Access	●	●	
	Easy Open Side Battery Access Door	○	○	
Battery Related	Battery with Easy Water Supply Apparatus	○	○	

# Load capacity curve 2-stage Free View Mast

## AE50 Series/Standard Truck

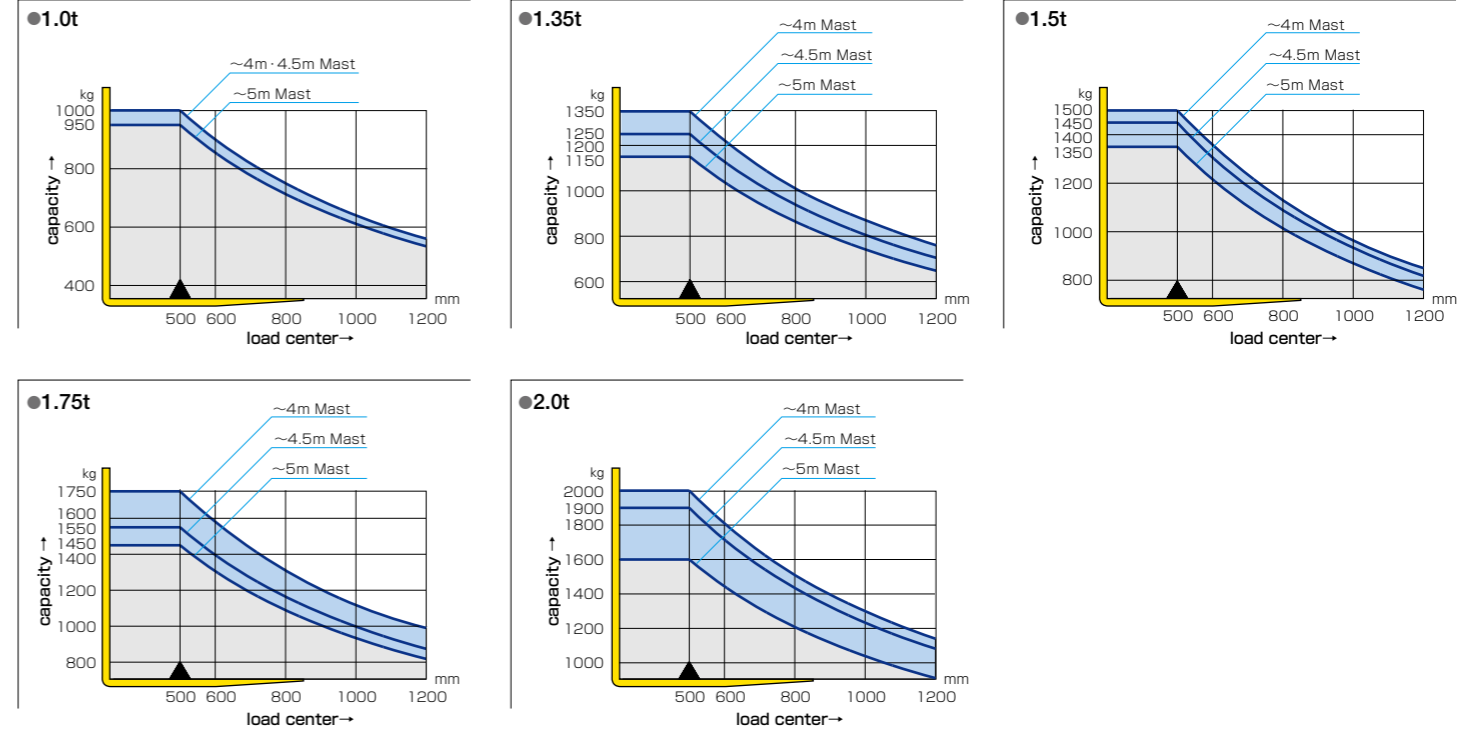

## AE50 Series/Large Capacity Battery Truck

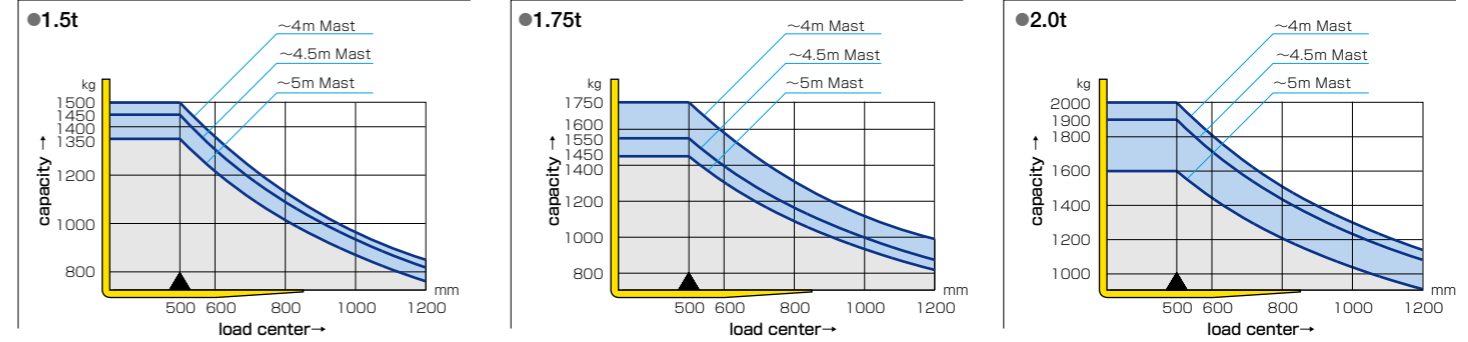

## AM50 Series

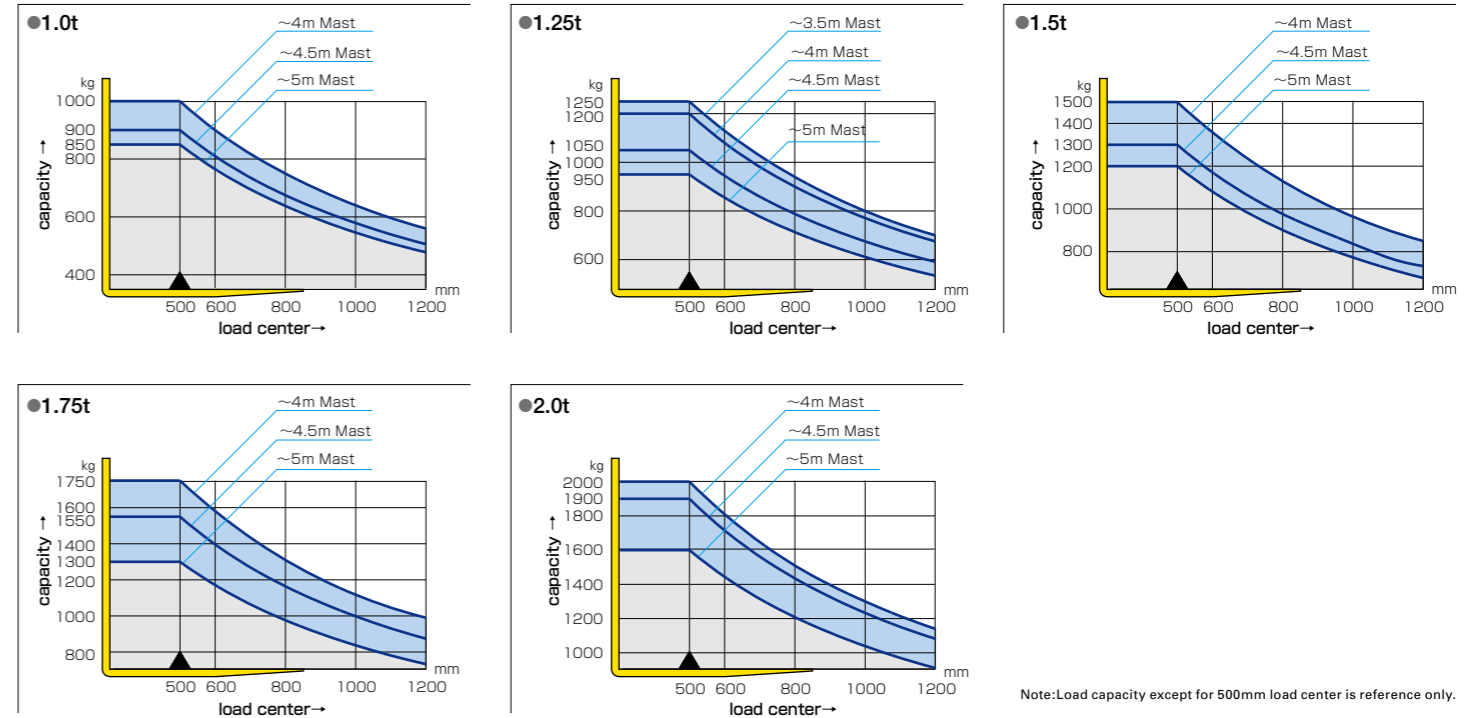

Note: Load capacity except for 500mm load center is reference only.